

MERAVO[®]

Rack机柜系列



北京盖非科技有限公司

BEIJING GAIFLY TECHNOLOGY CO.,LTD

地址：北京市顺义区空港融慧园海高大厦

电话：4008607228 Email: Gaifly@gaifly.com

Company Introduction

公司简介

盖非科技 (Gaifly.com) 是一家数据中心基础设施解决方案设计及产品提供商，旗下品牌名为Meravo (脉菲)。现有主要产品线包括：模块化数据中心解决方案、数据中心机柜系统、智能配电系统、数据中心基础设施管理系统、公共监视系统、通信基站系统、工业控制柜系统、智能终端柜系统等。

production capacity.

Production Equipment

生产设备



数控折弯机
CNC Bending Machine



阿玛达数控冲床
AMADAEMZ3510



数控折弯机
CNC Bending Machine



自动喷涂流水线
Automatic Spraying Line



德国通快激光切割机
TRUMPF Laser Cutting Machine



德国通快冲床
TRUMPF Punching Machine

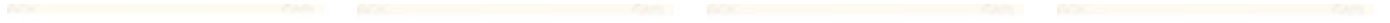

目录 Contents



冷通道封闭系统
Cold Aisle Containment System
P04



H5系列服务器机柜
Server Cabinet H5 Series
P18



户外防雨设备箱
Outdoor Cabinet
手提式配电箱
Temporary Distribution Cabinet
P31



智能一体化机柜
Intelligent Integrated Cabinet
P8



ZP系列服务器机柜
Server Cabinet ZP Series
P20



户外网络防雨柜
Outdoor Cabinet
P32



H1系列服务器机柜
Server Cabinet H1 Series
P10



ZP-A系列服务器机柜
Server Cabinet ZP-A Series
P22

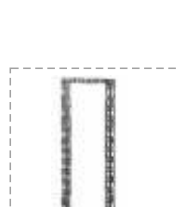

开放式机架
Open Rack
P33



H2系列服务器机柜
Server Cabinet H2 Series
P12



电力柜 (屏柜)
Distribution Cabinet
P24



E3-WM系列网络机柜
Network Cabinet F3-WM Series
P34



H3系列服务器机柜
Server Cabinet H3 Series
P14



屏蔽机柜 C级
Shielding Cabinet (Class C)
P26



E-WM系列网络机柜
Network Cabinet F-WM Series
P36



H4系列服务器机柜
Server Cabinet H4 Series
P16



E系列网络机柜
Network Cabinet E Series
P28



机柜常用配件
Cabinet Accessories
P37

数据中心冷通道封闭系统

Cold Aisle Containment System for Data Center



产品介绍

Product Introduction

-
-
-

-
-
-

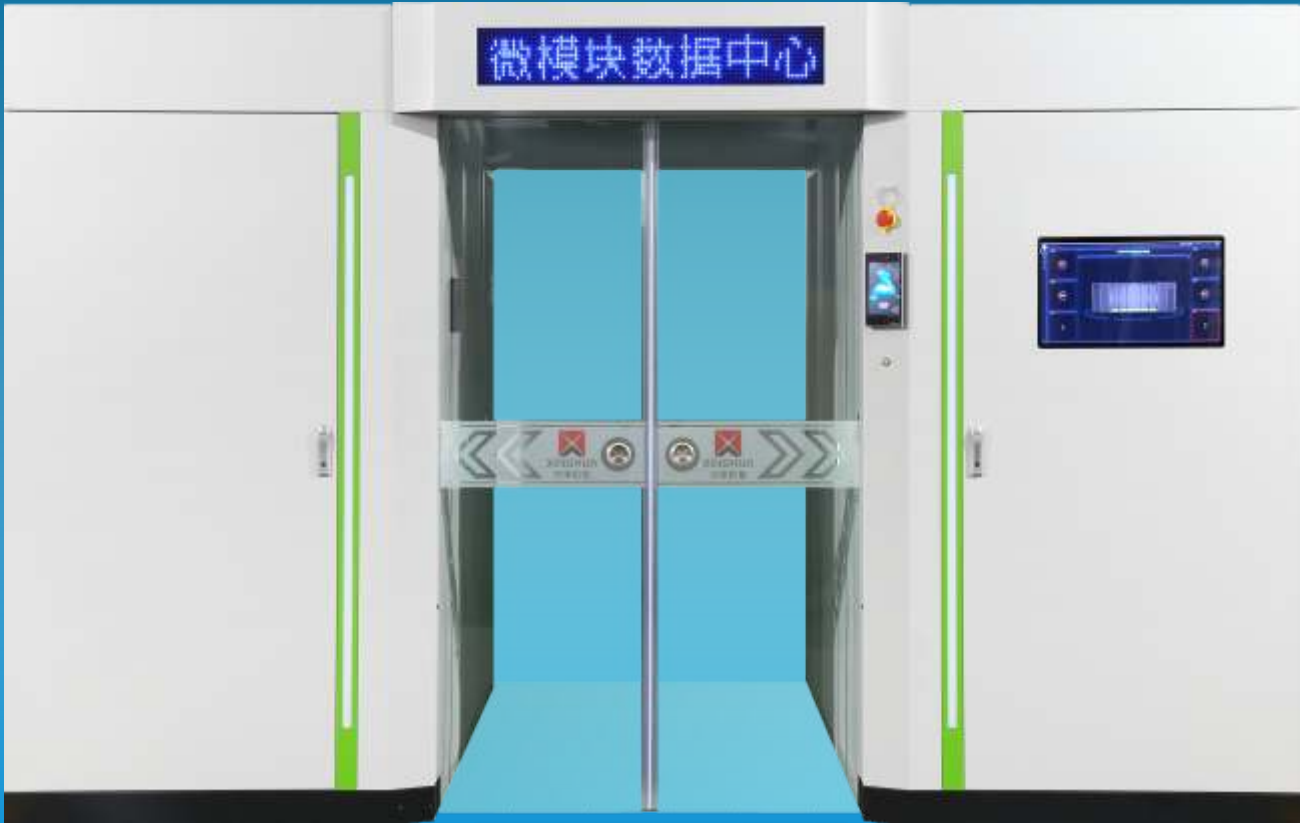

产品特性

- 简约** 解决方案产品化，全模块化架构，按需部署
- 绿色** 温控系统能耗降低 8-15%
- 智能** 智能3D可视化管理 配电、制冷容量关键信息及告警一目了然，自动化管理触摸大屏直观展示
- 安全** 智能供配电，供电链路可视，故障精准定位，主动隔离

产品特性

- Simplicity** Simplified solution productization, fully modular architecture, on-demand deployment
- Green** Temperature control system reduces energy consumption by 8-15%
- intelligence** intelligent 3D visualization management of key information on power distribution and cooling capacity
And alarms are clear at a glance, with automated management and intuitive display on the touch screen
- Safe** Intelligent power supply and distribution, visible power supply links, precise fault location, main Dynamic isolation

数据中心冷池示意图

Schematic diagram of cold aisle containment

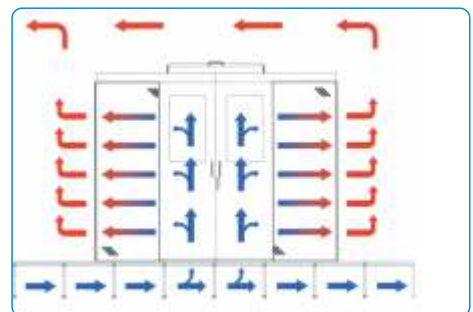
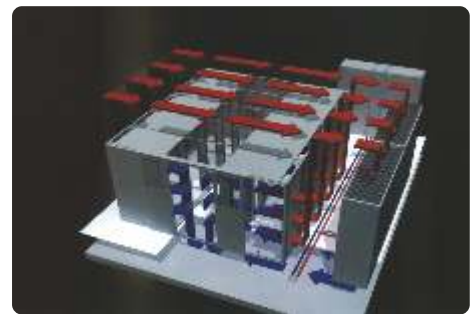

互联网数据中心机房冷通道 CAC for internet data center



冷通道细节实景
CAC Details



冷通道细节实景
CAC Details



冷通道细节实景
CAC Details



冷通道细节实景
CAC Details



冷通道细节实景
CAC Details



冷通道细节实景
CAC Details

智能一体化机柜 Intelligent Integrated Cabinet

产品概述 Overview

智能一体化机房按照数据中心机房标准设计，在系统中集成了制冷、配电、监控、UPS及蓄电池、综合布线等模块，形成以柜级为单位的智能微型机房，为IT设备提供安全稳定运行的电力及环境保障；是传统机房的小型独立版本。

Intelligent integrated computer room according to data center machine Standard room design, integrating refrigeration Power distribution, monitoring, UPS and battery, comprehensive layout Line and other modules, forming intelligence on a cabinet level basis Micro computer room provides secure and stable operation for IT equipment Electricity and environmental protection; It's from a traditional computer room Small standalone version.



应用场景 Application Scenario

银行、证券、保险营业网点
小型变电站、小型发电厂
分支机构网络配线间
中小企业计算机房
运营商营业厅
中小学普教行业
能源、化工行业中控室
公路、轨道交通沿线控制室
企业和政府办公室、派出所



- Banking, securities, and insurance business outlets
- Small substations, small power plants
- Branch office network wiring room
- Small and medium-sized enterprise computer room
- Operator Business Hall
- Primary and secondary education industry
- Energy and chemical industry central control room
- Control rooms along highways and rail transit lines
- Corporate and government offices, police stations

产品特点 Product Features

- ◆ **安全可靠** Safe and reliable
- ◆ **快速部署** Rapid Deployment
- ◆ **投入低廉** Low investment
- ◆ **高度集成** highly integration
- ◆ **全面监控** Comprehensive monitoring
- ◆ **节能静音** Energy saving mute

表现形式 Expressions



依据不同的应用需求，分为单柜和排柜两种形态

According to different application requirements, it can be divided into two forms: single cabinet and row cabinet

关键技术 key technology



H1系列服务器机柜 Server Cabinet H1 Series



型号/ Model:H1

H1系列机柜标准配置 Cabinet Package Contents:

- | | | | |
|-----------|---------------------------|-----------|----------------------------|
| ● 框架1个 | Cabinet Frame 1pc | ● 侧板6个 | Side Panel 6pcs |
| ● 通风顶盖1个 | Top Cover 1pc | ● 底框1个 | Bottom Frame 1pc |
| ● 网孔前门1扇 | Vented front door 1pc | ● 双开后门1对 | Split rear door 1 pair |
| ● 卡母+螺丝1包 | Cage nuts&screws 1bag | ● 平衡地脚4只 | leveling feet 4pcs |
| ● 脚轮4只 | Castor 4pcs | ● 柜门钥匙1套 | Keys 1set |
| ● 并柜件6个 | Combined accessories 6pcs | ● 金属理线环6个 | Cable management ring 6pcs |

规格参数Specification

订购代码	容量	尺寸	整装体积
Model No.	Capacity	Dimension	Assembled packing(CBM)
H16842	42U	600x800mm	1.10
H16042		600x1000mm	1.40
H16142		600x1100mm	1.60
H16242		600x1200mm	1.70
H18842		800x800mm	1.50
H18042		800x1000mm	1.85
H18142		800x1100mm	2.00
H18242		800x1200mm	2.20

- 机柜标准: 符合GB/T3047.2-92标准, 兼容19"国际标准、公制标准和ETSI标准。
- 机柜材质: 立梁(方孔条)和横梁均为耐指纹覆铝锌板。主体框架为九折型材, 其他为SPCC优质冷轧钢板制做。
- 材料厚度: 立梁(方孔条): 2.0mm, 横梁: 1.5mm, 其他: 1.2mm。
- 承重: 额定静载≤1300Kg。
- 防护等级: IP20。
- 柜门通风率: ≥75%。
- 面处理: 脱脂、酸洗、磷化、静电喷涂。
- 颜色: RAL9004(黑色), RAL7035(灰白)。

- Standard: Comply with ANSI/EIARS-310-D, DIN41491; PART 1, IEC297-2, DIN41494; PART7, GB/T3047.2-92 standard. Compatible with metric ETSI and 19 inch international standard.
- Material: Zinc plated mounting profiles, SPCC Cold rolled steel. Cabinet frame: Nine-fold section steel.
- Material thickness: Mounting profile: 2.0mm, mounting rails: 1.5mm, others: 1.2mm.
- Loading Capacity: 1300kg.
- Protection grade: IP20.
- Ventilation Rate of Cabinet doors: ≥75%.
- Surface Finish: Degreasing, Pickling, Phosphating, Powder coating.
- Color: RAL9004(Black), RAL7035(Grey white).



顶盖多处设有进线孔
Cable entrance on the top cover

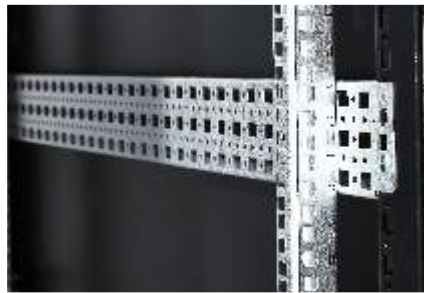

可前后调节的覆铝锌方孔条
The zincalume mounting profile could be adjustable



散热风扇组
Cooling fan unit



金属理线环
Metal cable management ring



六角网孔门安装雅典锁
Installation of Athens lock for hexagonal mesh door



底板多处设有进线孔
Multiple inlet holes are installed on the bottom plate

H2系列服务器机柜 Server Cabinet H2 Series



型号/ Model:H2

H2系列机柜标准配置 Cabinet Package Contents:

- | | | | |
|-----------|---------------------------|----------|----------------------------|
| ● 框架1个 | Cabinet Frame 1pc | ● 侧板2个 | Side Panel 2pcs |
| ● 通风顶盖1个 | Top Cover 1pc | ● 底框1个 | Bottom Frame 1pc |
| ● 网孔前门1扇 | Vented front door 1pc | ● 双开后门1对 | Split rear door 1 pair |
| ● 卡母+螺丝1包 | Cage nuts&screws 1bag | ● 平衡地脚4只 | leveling feet 4pcs |
| ● 脚轮4只 | Castor 4pcs | ● 柜门钥匙1套 | Keys 1set |
| ● 并柜件6个 | Combined accessories 6pcs | ● 金属理线环 | Cable management ring 6pcs |

规格参数Specification

订购代码	容量	尺寸	整装体积
Model No.	Capacity	Dimension	Assembled packing(CBM)
H26842	42U	600x800mm	1.10
H26042		600x1000mm	1.40
H26142		600x1100mm	1.60
H26242		600x1200mm	1.70
H28842		800x800mm	1.50
H28042		800x1000mm	1.85
H28142		800x1100mm	2.00
H28242		800x1200mm	2.20

- 机柜标准: 符合GB/T3047.2-92标准, 兼容19"国际标准、公制标准和ETSI标准。
- 机柜材质: 立梁(方孔条)和横梁均为耐指纹覆铝锌板。主体框架为九折型材, 其他为SPCC优质冷轧钢板制做。
- 材料厚度: 立梁(方孔条): 2.0mm, 横梁: 1.5mm, 其他: 1.2mm。
- 承重: 额定静载≤1300Kg。
- 防护等级: IP20。
- 柜门通风率: ≥75%。
- 面处理: 脱脂、酸洗、磷化、静电喷涂。
- 颜色: RAL9004(黑色), RAL7035(灰白)。

- Standard: Comply with ANSI/EIARS-310-D, DIN41491; PART 1, IEC297-2, DIN41494; PART7, GB/T3047.2-92 standard. Compatible with metric ETSI and 19 inch international standard.
- Material: Zinc plated mounting profiles, SPCC Cold rolled steel. Cabinet frame: Nine-fold section steel.
- Material thickness: Mounting profile: 2.0mm, mounting rails: 1.5mm, others: 1.2mm.
- Loading Capacity: 1300kg.
- Protection grade: IP20.
- Ventilation Rate of Cabinet doors: ≥75%.
- Surface Finish: Degreasing, Pickling, Phosphating, Powder coating.
- Color: RAL9004(Black), RAL7035(Grey white).



可提供OEM加工
OEM service



前门锁
Lock for front door



后门锁
Lock for split rear door



底部走线孔
Cable entrances on the bottom



带U标识覆铝锌方孔条
Zinc plated mounting profile with 'U' Mark



金属理线环
Cable management ring

H3系列服务器机柜 Server Cabinet H3 Series



型号/ Model:H3

H3系列机柜标准配置 Cabinet Package Contents:

- | | | | |
|-----------|---------------------------|----------|------------------------|
| ● 框架1个 | Cabinet Frame 1pc | ● 侧板4个 | Side Panel 4pcs |
| ● 通风顶盖1个 | Top Cover 1pc | ● 底框1个 | Bottom Frame 1pc |
| ● 网孔前门1扇 | Vented front door 1pc | ● 双开后门1对 | Split rear door 1 pair |
| ● 卡母+螺丝1包 | Cage nuts&screws 1bag | ● 平衡地脚4只 | leveling feet 4pcs |
| ● 脚轮4只 | Castor 4pcs | ● 柜门钥匙1套 | Keys 1set |
| ● 并柜件6个 | Combined accessories 6pcs | | |

规格参数Specification

订购代码	容量	尺寸	整装体积
Model No.	Capacity	Dimension	Assembled packing(CBM)
H36042	42U	600x1070mm	1.10
H38042		800x1070mm	1.40

- 机柜标准: 符合GB/T3047.2-92标准, 兼容19"国际标准、公制标准和ETSI标准。
- 机柜材质: 立梁(方孔条)和横梁均为耐指纹覆铝锌板。主体框架为九折型材, 其他为SPCC优质冷轧钢板制做。
- 材料厚度: 立梁(方孔条): 2.0mm, 横梁: 1.5mm, 其他: 1.2mm。
- 承重: 额定静载≤1300Kg。
- 防护等级: IP20。
- 柜门通风率: ≥75%。
- 面处理: 脱脂、酸洗、磷化、静电喷涂。
- 颜色: RAL9004(黑色), RAL7035(灰白)。

- Standard: Comply with ANSI/EIARS-310-D, DIN41491; PART 1, IEC297-2, DIN41494; PART7, GB/T3047.2-92 standard. Compatible with metric ETSI and 19 inch international standard.
- Material: Zinc plated mounting profiles, SPCC Cold rolled steel. Cabinet frame: Nine-fold section steel.
- Material thickness: Mounting profile: 2.0mm, mounting rails: 1.5mm, others: 1.2mm.
- Loading Capacity: 1300kg.
- Protection grade: IP20.
- Ventilation Rate of Cabinet doors: ≥75%.
- Surface Finish: Degreasing, Pickling, Phosphating, Powder coating.
- Color: RAL9004(Black), RAL7035(Grey white).



顶部配备带防尘毛刷
Top cover with brush for cabling



带'U'数标识的方孔条
Mounting profile with "U" mark



人性化设计的理线板
Cable management



两段式侧板带快开式门锁
Side panel with quick opening lock



圆网孔门配备了高档三点弹力锁
Circular holes mesh door with split lock



带通风孔的托盘
Ventilated fixed shelf

H4系列服务器机柜 Server Cabinet H4 Series



型号/ Model:H4

H4系列机柜标准配置 Cabinet Package Contents:

- | | | | |
|-----------|---------------------------|-----------|---------------------------------|
| ● 框架1个 | Cabinet Frame 1pc | ● 侧板4个 | Side Panel 4pcs |
| ● 通风顶盖1个 | Top Cover 1pc | ● 底板1个 | Bottom Panel 1pc |
| ● 网孔前门1扇 | Vented Font Door 1pc | ● 双开后门1对 | Double Open Back Mesh Door 1set |
| ● 卡母+螺丝1包 | Cage Nuts&Screws 1bag | ● 平衡地脚4只 | Leveling Feet 4pcs |
| ● 脚轮4只 | Castor 4pcs | ● 柜门钥匙1套 | Key 1set |
| ● 并柜件6个 | Combined Accessories 6pcs | ● 金属理线环6个 | Cable Manager Ring 6pcs |

规格参数Specification

订购代码	容量	尺寸	整装体积
Model No.	Capacity	Dimension	Assembled packing(CBM)
H4-6042	42U	600x1000mm	1.4
H4-6142		600x1100mm	1.55
H4-6242		600x1200mm	1.7
H4-8042		800x1000mm	1.83
H4-8142		800x1100mm	2
H4-8242		800x1200mm	2.2
H4-6247	47U	600x1000mm	1.55
H4-6147		600x1100mm	1.7
H4-6247		600x1200mm	1.83
H4-8047		800x1000mm	2
H4-8147		800x1100mm	2.2
H4-8247		800x1200mm	2.4

- 机柜标准: 符合GB/T3047.2-92标准, 兼容19"国际标准、公制标准和ETSI标准。
- 机柜材质: 主体框架为九折型材, 前门左右门边为铝合金, 立梁(方孔条), 横梁耐指纹覆铝锌板。其他为SPCC优质冷轧钢板制做。
- 材料厚度: 立梁(方孔条): 2.0mm, 横梁: 1.5mm, 其他: 1.2mm。
- 承重: 额定静载 ≤ 1300Kg。
- 防护等级: IP20。
- 柜门通风率: ≥ 75%。
- 表面处理: 脱脂、水洗、陶化、水洗、静电喷涂。
- 颜色: RAL9004(黑色), RAL7035(灰白)。
- Standard: Comply with GB/T3047.2-92 standard. Compatible with metric ETSI and 19 inch international standard.
- Material: The main frame is nine fold profile; the border of front door is aluminum alloy; the mounting profile and horizontal mounting rails are fingerprint resistant aluminum zinc plate. Others are made of SPCC cold rolled steel.
- Material Thickness: Mounting profile : 2.0 mm, horizontal mounting rails: 1.5mm, others: 1.2mm.
- Loading Capacity: 1300kgs.
- Protection Grade: IP20.
- Ventilation Rate of Cabinet Doors: ≥ 75%.
- Surface Finish: Degreasing, washing, ceramics, washing, electrostatic spraying.
- Color: RAL9004(Black), RAL7035(grey white)



顶盖多处设有进线孔
Cable entrance on the top cover

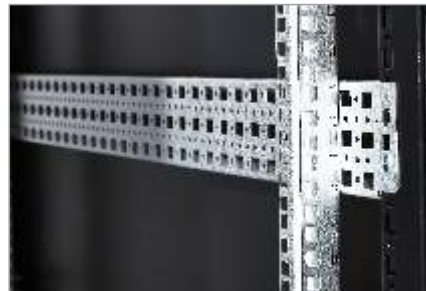

可前后调节的覆铝锌方孔条
The zincalume mounting profile could be adjustable



散热风扇组
Cooling fan unit



金属理线环
Metal cable management ring



六角网孔门安装雅典锁
Installation of Athens lock for hexagonal mesh door



底板多处设有进线孔
Multiple inlet holes are installed on the bottom plate

H5系列服务器机柜 Server Cabinet H5 Series



型号/ Model:H5

H5系列机柜标准配置 Cabinet Package Contents:

- | | | | |
|-----------|-----------------------|----------|---------------------------------|
| ● 框架1个 | Cabinet Frame 1pcs | ● 侧板2个 | Side Panel 2pcs |
| ● 通风顶盖1个 | Top Cover 1pc | ● 底板1个 | Bottom Panel 1pc |
| ● 网孔前门1扇 | Vented Front Door 1pc | ● 双开后门1对 | Double Open Back Mesh Door 1set |
| ● 卡母+螺丝1包 | Cage Nuts&Screws 1bag | ● 平衡地脚4只 | Leveling Feet 4pcs |
| ● 脚轮4只 | Castor 4pcs | ● 柜门钥匙1套 | Key 1set |

规格参数Specification

订购代码	容量	尺寸	整装体积
Model No.	Capacity	Dimension	Assembled packing(CBM)
H5-6042	42U	600x1000mm	1.4
H5-6142		600x1100mm	1.55
H5-6242		600x1200mm	1.7
H5-8042		800x1000mm	1.83
H5-8142		800x1100mm	2
H5-8242		800x1200mm	2.2
H5-6247	47U	600x1000mm	1.55
H5-6147		600x1100mm	1.7
H5-6247		600x1200mm	1.83
H5-8047		800x1000mm	2
H5-8147		800x1100mm	2.2
H5-8247		800x1200mm	2.4

- 机柜标准: 符合GB/T3047.2-92标准, 兼容19"国际标准、公制标准和ETSI标准。
- 机柜材质: 主体框架为十六折型材, 立梁(方孔条), 横梁为镀锌板。其他为SPCC优质冷轧钢板制做。
- 材料厚度: 立梁(方孔条): 2.0mm, 横梁: 1.5mm, 其他: 1.2mm。
- 承重: 额定静载≤1300Kg。
- 防护等级: Ip20。
- 柜门通风率: ≥75%。
- 表面处理: 脱脂、水洗、陶化、水洗、静电喷涂。
- 颜色: RAL9004(黑色), RAL7035(灰白)。
- Standard:
Comply with GB/T3047.2- 92 standard. Compatible with metric ETSI and 19 inch international standard.
- Material:
The main frame is sixteen fold profile; the border of front door is aluminum alloy; the mounting profile and horizontal mounting rails are fingerprint resistant aluminum zinc plate. Others are made of SPCC cold rolled steel.
- Material Thickness:
Mounting profile : 2.0 mm, horizontal mounting rails:1.5mm, others:1.2mm.
- Loading Capacity:1300kgs.
- Protection Grade:IP20.
- Ventilation Rate of Cabinet doors:≥75%.
- Surface Finish:
Degreasing, washing, ceramics, washing, electrostatic spraying.
- Color: RAL9004(Black), RAL7035(grey white)



可前后调节的方孔条立柱
Adjustable square hole bar column



六角网孔门安装MS867锁
Installation of MS867 lock for hexagonal mesh door

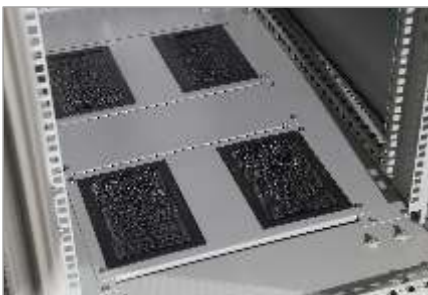

底板预制走线孔毛刷封闭
Sealing of prefabricated wiring holes on the bottom plate with brush



加强型前后网孔门
Reinforced front and rear mesh door



型号/ Model:ZP

特征:应用于大小数据机房服务器机柜

ZP系列机柜标准配置 Cabinet Package Contents:

- | | | | |
|-----------|---------------------------|----------|--------------------|
| ● 框架1个 | Cabinet Frame 1pc | ● 底板1个 | Bottom Panel 1pc |
| ● 顶板1个 | Top Cover 1pc | ● 理线板2根 | Cable Manager 2pcs |
| ● 前网门1个 | Front Mesh Door 1pc | ● 脚轮4只 | Castor 4pcs |
| ● 后双开网门1套 | Back Split Mesh door 1set | ● 平衡地脚4只 | Leveling Feet 4pcs |
| ● 侧板4块 | Side Panel 4pcs | | |

规格参数 Specification

订购代码	容量	尺寸	整装体积
Model No.	Capacity	Dimension	Assembled packing(CBM)
ZP-6042	42U	600x1000x2000mm	1.4
ZP-6142		600x1100x2000mm	1.55
ZP-6242		600x1200x2000mm	1.7
ZP-8042		800x1000x2000mm	1.83
ZP-8142		800x1100x2000mm	2
ZP-8242		800x1200x2000mm	2.2
ZP-6247	47U	600x1000x2200mm	1.55
ZP-6147		600x1100x2200mm	1.7
ZP-6247		600x1200x2200mm	1.83
ZP-8047		800x1000x2200mm	2
ZP-8147		800x1100x2200mm	2.2
ZP-8247		800x1200x2200mm	2.4

- 机柜标准: 符合GB/T3047.2-92标准, 兼容19"国际标准、公制标准和ETSI标准。
 - 机柜材质: 主体框架为G型材, 全部采用SPCC优质冷轧钢板制做。
 - 材料厚度: 立梁(方孔条): 2.0mm, 框架、横梁: 1.5mm, 其他: 1.2mm。
 - 承重: 额定静载 ≤ 2500Kg。
 - 防护等级: Ip20。
 - 柜门通风率: ≥ 75%。
 - 表面处理: 脱脂、水洗、陶化、水洗、静电喷涂。
 - 颜色: RAL9004(黑色), RAL7035(灰白)。
- Standard: Comply with the standard of GB/T3047.2-92 Compatible with 19 inch international standard, metric and ETSI standard.
 - Material: Main frame is made of G profile, others are made of SPCC Cold rolled steel.
 - Material thickness: Mounting profile : 2.0mm, frame, mounting rails: 1.5mm, mothers: 1.2mm.
 - Loading Capacity: 2500kgs.
 - Protection grade: IP20.
 - Ventilation Rate of Cabinet doors: ≥ 75%.
 - Surface Finish: Degreasing, washing, ceramics, washing, electrostatic spraying.
 - Color: RAL9004(Black), RAL7035(grey white)



竖装理线板
Vertical cable manager



三点式旋转机械锁
Three-point rotating mechanical lock



顶板进线孔安装毛刷

Cable entrance for brush on top cover



底板预制走线孔
Pre-punched holes for cabling



散热风机组(选配)
Cooling fan unit(Optional)

ZP-A系列服务器机柜 Network Cabinet ZP-A Series



型号/ Model: ZP-A

特征:应用于小型数据机房服务器机柜。

ZP-A系列机柜标准配置 Cabinet Package Contents:

- | | | | |
|-----------|---------------------------|-----------|--------------------|
| ● 框架1个 | Cabinet Frame 1pc | ● LED灯带1条 | Led light 1pc |
| ● 顶板1个 | Top Cover 1pc | ● 底板1个 | Bottom Panel 1pc |
| ● 前网门1个 | Front mesh door 1pc | ● 理线板2根 | Cable manager 2pcs |
| ● 后双开网门1套 | Back split mesh door 1set | ● 脚轮4只 | Castor 4pcs |
| ● 侧板4块 | Side Panel 4pcs | ● 平衡地脚4只 | leveling feet 4pcs |

规格参数Specification

订购代码	容量	尺寸	整装体积
Model No.	Capacity	Dimension	Assembled packing(CBM)
ZP-A6042	42U	600x1000x2000mm	1.4
ZP-A6142		600x1100x2000mm	1.55
ZP-A6242		600x1200x2000mm	1.7
ZP-A8042		800x1000x2000mm	1.83
ZP-A8142		800x1100x2000mm	2
ZP-A8242		800x1200x2000mm	2.2
ZP-A6247	47U	600x1000x2200mm	1.55
ZP-A6147		600x1100x2200mm	1.7
ZP-A6247		600x1200x2200mm	1.83
ZP-A8047		800x1000x2200mm	2
ZP-A8147		800x1100x2200mm	2.2
ZP-A8247		800x1200x2200mm	2.4

- 机柜标准: 符合GB/T3047.2-92标准, 兼容19"国际标准、公制标准和ETSI标准。
- 机柜材质: 主体框架为G型材, 全部采用SPCC优质冷轧钢板制做。
- 材料厚度: 立梁(方孔条): 2.0mm, 框架、横梁: 1.5mm, 其他: 1.2mm。
- 承重: 额定静载≤2500Kg。
- 防护等级: Ip20。
- 柜门通风率: ≥75%。
- 表面处理: 脱脂、水洗、陶化、水洗、静电喷涂。
- 颜色: RAL9004(黑色), RAL7035(灰白)。

- Standard: Comply with the standard of GB/T3047.2-92. Compatible with 19 inch international standard, metric and ETSI standard.
- Material: Main frame is made of G profile, others are made of SPCC Cold rolled steel.
- Material thickness: Mounting profile : 2.0mm, frame, mounting rails: 1.5mm, others: 1.2mm.
- Loading Capacity: 2500kgs.
- Protection grade: IP20.
- Ventilation Rate of Cabinet doors: ≥75%.
- Surface Finish: Degreasing, washing, ceramics, washing, electrostatic spraying.
- Color: RAL9004(Black), RAL7035(grey white)

电力柜（屏柜） Distribution Cabinet



型号/ Model: 电力柜（屏柜）



顶部出风孔焊接滤网
Filter on the top ventilation hole



可拆卸进线孔
Cable entrance



后左门焊接文件盒
File box on the rear left door



前玻璃门安装缓冲气动杆
Buffer- pneumatic rod on the front glass door



前、后门、侧板安装透明4mm²透明接地线
4mm² ground wire on front, rear door and side panel

● 引用 DL/T 720-2000 (电力系统继电保护柜、屏通用技术条件) 满足国家其他相关规程、规定的要求技术标准。主要应用于电力系统中小型发电厂、各类变电站、电子控制行业、综合通信等。

● 屏柜尺寸, 2260 × 800 × 600 (高 × 宽 × 深) mm, 柜净高 2200mm, 门楣高 60mm。

● 结构

1: 框架: 机柜采用焊接结构, 前、后门、侧板内嵌式。

2: 前后门: 前单玻璃门, 后双开钣金门, 前后门采用 MS828 型号门锁 (钥匙通用) 三点式锁定。

3: L侧板: 屏柜侧面可快速拆卸的侧门, 侧门锁不凸出框架平面, 不影响并柜。

4: 屏柜底部设有四个 16 × 60 长圆形安装孔, 左右中心距为 660mm, 前后中心距为 508mm。

在屏底后部设有四块可拆卸的底板。

5: 屏柜顶部设有通风孔, 通风孔上部装有防尘罩, 安装 60mm 门楣, 4 个 M12 吊环。

6: 配置; 焊接框架 1 套, 前玻璃门 1 块, 后双开门 1 套, 左右大侧板共 2 块、小侧板 2 块, 立柱 4 根, PVC 线槽 2 根, 铝合金导轨 2 根。

● 板材厚度 框架、安装梁、前门 1.5mm, 后门、侧板 1.2mm, 立柱 2.0mm。

● 表面处理: 脱脂、水洗、陶化、水洗、静电喷涂

● 颜色: RAL7035 (灰白), 可按客户需求定制颜色。

● Reference to DL/T 720 -2000 (General specification for relay protection cabinet and screen of power system). Comply with other relevant regulations and technical standards of the state. Mainly applied in small and medium -sized power plants, all kinds of substations, electronic control industry, integrated communications etc.

● Cabinet size: 2260 × 800 × 600 mm (height × width × depth) mm, net height 2200 mm, lintel height 60 mm.

● Structure

1. Frame: welded structure, the front, back door and side panel are embedded.

2. Front and back doors: front single glass door, back split metal door, three-point locks (model no. MS828) for front and back door.

3. Side panel: Removable. The lock on side panel doesn't affect the combination of the cabinet.

4. The bottom has four 16x60 round mounting holes, with a center distance of 660mm from left to right and a center distance of 508mm from front to back. Four removable bottom panels are at the back of the cabinet.

5. The top cover has ventilation hole with dust cover, for fixing 60mm lintel and 4 pcs M12 rings.

6. Package Contents: Welded frame 1 set, front glass door 1 pc, rear split door 1 set, big side panels 2 pcs, small side panels 2 pcs, mounting profile 4 pcs, PVC cable manager 2 pcs, aluminum guide rail 2 pcs.

● Material thickness:

Mounting profile: 2.0mm

Frame, mounting rail, front door: 1.5mm;

Rear door, side panel: 1.2mm

● Surface Finish:

Degreasing, washing, ceramics, washing, electrostatic spraying.

● Color: RAL9004 (Black), RAL7035 (grey white)

屏蔽机柜 C级 Shielding Cabinet (Class C)



型号/ Model:PB

特征:C级电磁防泄漏，应用于保密、涉密。

Feature: Class C electromagnetic, anti-leakge, applied to confidentiality

屏蔽机柜标准配置 Cabinet Package Contents:

- | | | | |
|----------|--------------------------|------------|--|
| ● 柜体1个 | Cabinet Frame 2pcs | ● 电源滤波器1套 | Power Filter 1set |
| ● 风扇4个 | Top Cover 1pc | ● 网线波导管10个 | Wave Guide Tube for Cable 10pcs |
| ● 屏蔽前门1扇 | Shielding Front Door 1pc | ● 光纤线波导管5个 | Wave Guide Tube for Fiber Optic Cable 5pcs |
| ● 波导窗1个 | Waveguide Window 1pc | ● 平衡地脚4只 | Leveling Feet 4pcs |
| ● 脚轮4只 | Castor 4pcs | ● 电子锁1套 | Electronic Lock 1set |

规格参数Specification

订购代码	容量	尺寸	内部尺寸
Model No.	Capacity	Dimension	Internal dimension
PB-7718	14U	700x700x1000mm	19 "x550x620mm
PB-7018		700x1000x1000mm	19 "x870x620mm
PB-7720	20U	700x700x1250mm	19 "x550x900mm
PB-7020		700x1000x1250mm	19 "x870x900mm
PB-7726	26U	700x700x1550mm	19 "x550x1200mm
PB-7026		700x1000x1550mm	19 "x870x1200mm
PB-7733	33U	700x700x1850mm	19 "x550x1500mm
PB-7033		700x1000x1850mm	19 "x870x1500mm
PB-7737	37U	700x700x2000mm	19 "x550x1650mm
PB-7037		700x1000x2000mm	19 "x870x1650mm
PB-7742	42U	700x700x2200mm	19 "x550x1850mm
F3AS8042		700x1000x2200mm	19 "x870x1850mm

- 机柜标准: 满足国家保密标准BMB19-2006 电磁泄露发射屏蔽机柜技术要求和测试方法 的C级标准;
4KHz ≥ 70dB 150KHz ≥ 100dB
450MHz ≥ 100dB 930MHz ≥ 100dB

测试方法按BMB3-2006标准:

符合GB/T3047.2-92标准, 兼容19"国际标准、公制标准和ETSI标准。

- 机柜材质: 柜体、前门、方孔条立柱、采用镀锌板, 其他为SPCC优质冷轧钢板制做。

- 材料厚度: 柜体、前门、顶板、横梁1.5mm, 立梁(方孔条): 2.0mm, 其他: 1.0-2.0mm。

- 承重: 额定静载 ≤ 1200Kg。

- 表面处理: 脱脂、水洗、陶化、水洗、静电喷涂。

- 颜色: RAL9004 (黑色)。

- Standard: Comply with national standard of confidentiality BMB 19-2006, "Class C standard for technical requirements and testing methods of electromagnetic leakage emission for shielding cabinets"
4KHz ≥ 70dB 150KHz ≥ 100dB
450MHz ≥ 100dB 930MHz ≥ 100dB

The testing methods refer to the standard of BMB3-2006:

Comply with the standard of GB/T3047.2-92. Compatible with 19 inch international standard, metric and ETSI standard.

- Material: Cabinet frame, front door, mounting profile are Zinc plated, others are made of SPCC Cold rolled steel.

- Material thickness: Cabinet frame, front door, top cover, mounting rail: 1.5mm, mounting profile: 2.0mm, others: 1.0-2.0mm.

- Loading Capacity: 1200kgs.

- Surface Finish: Degreasing, washing, ceramics, washing, electrostatic spraying.

- Color: RAL9004(Black)



顶部风扇
Top fan units



顶部蜂窝状波导窗
Top honeycomb waveguide window



电源滤波器
Power filter



波导管
Waveguide Tube



电子密码锁
Electronic coded lock



液晶数显温湿度
LCD digital display with
temperature and humidity



型号/ Model:E

前后单开平网门

Feature: Vented single front door and rear door.

E系列机柜标准配置 Cabinet Package Contents:

- | | | | |
|-----------|-----------------------|----------|----------------------------|
| ● 框架2个 | Cabinet Frame 2pcs | ● 侧板2个 | Side Panel 2pcs |
| ● 通风顶盖1个 | Top Cover 1pc | ● 底板1个 | Bottom Panel 1pc |
| ● 网孔前门1扇 | Vented front door 1pc | ● 单开网孔后门 | Single open mesh back door |
| ● 卡母+螺丝1包 | Cage nuts&screws 1bag | ● 平衡地脚4只 | leveling feet 4pcs |
| ● 脚轮4只 | Castor 4pcs | ● 柜门钥匙1套 | Keys 1set |

E系列网络机柜分解图

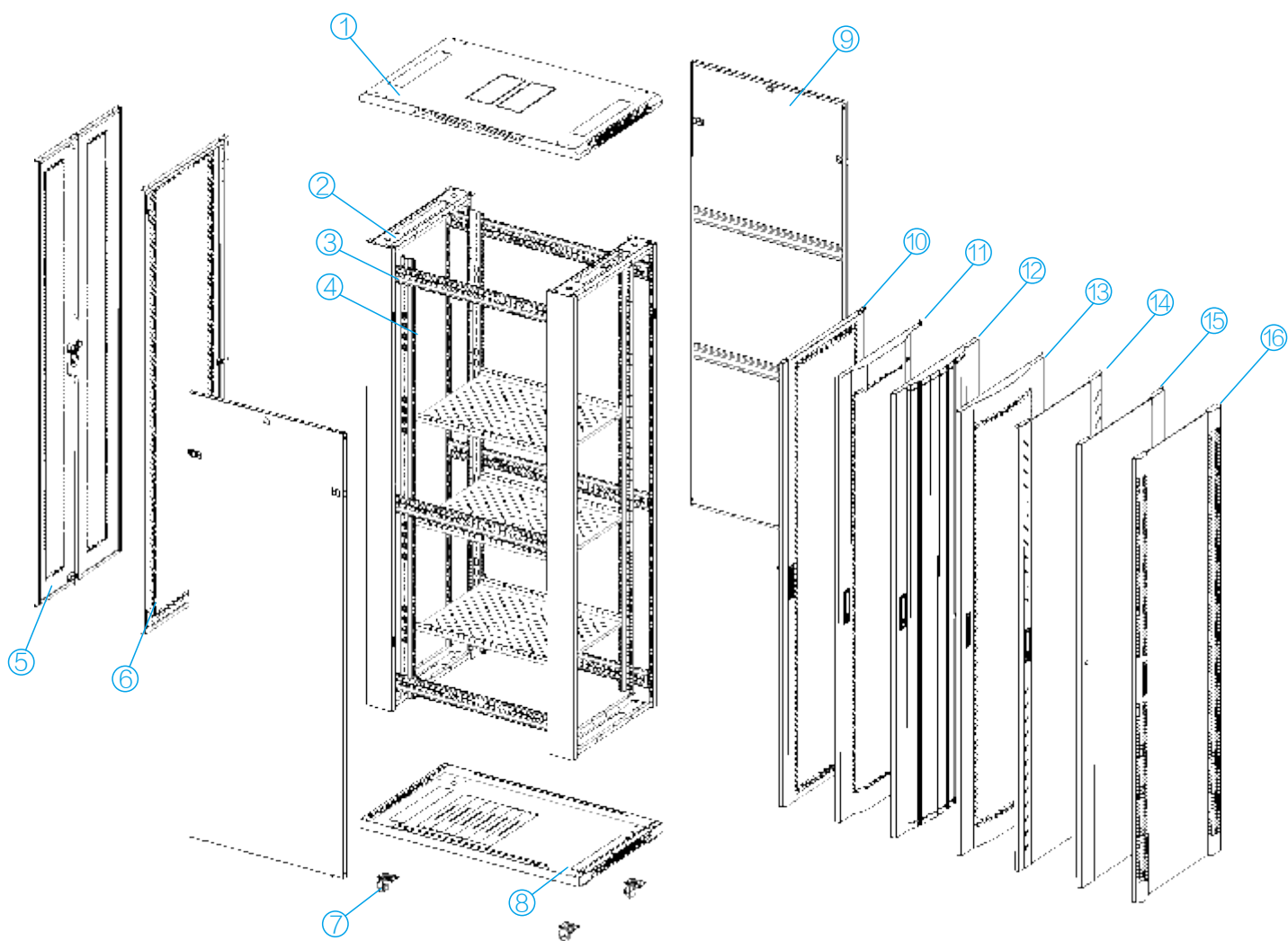

1.通风顶盖

2.框架

3.安装梁

4.方孔条

5.双开六角后网孔门

6.单开六角后网孔门

7.脚轮

8.底板

9.侧板

10.A3前门

11.AB前门

12.AD前门

13.AY前门

14.ES前门

15.A2前门

16.ES前门

规格参数Specification

订购代码	容量	尺寸	整装体积	散装体积
Model No.	Capacity	Dimension	Assembled packing(CBM)	Unassembled packing(CBM)
E-6618	18U	600x600mm	0.40	0.17
E-6818		600x800mm	0.53	0.20
E-6018		600x1000mm	0.65	0.23
E-6622	22U	600x600mm	0.49	0.20
E-6822		600x800mm	0.63	0.25
E-6022		600x1000mm	0.78	0.30
E-6627	27U	600x600mm	0.57	0.23
E-6827		600x800mm	0.75	0.29
E-6027		600x1000mm	0.93	0.34
E-6632	32U	600x600mm	0.66	0.28
E-6832		600x800mm	0.87	0.33
E-6032		600x1000mm	1.10	0.38
E-6637	37U	600x600mm	0.75	0.30
E-6837		600x800mm	0.99	0.35
E-6037		600x1000mm	1.23	0.42
E-6642	42U	600x600mm	0.84	0.32
E-6842		600x800mm	1.10	0.38
E-6042		600x1000mm	1.37	0.46
E-8842		800x800mm	1.50	0.43
E-8042		800x1000mm	1.82	0.54
E-8242		800x1200mm	2.16	0.61

- 机柜标准: 符合GB/T3047.2-92标准, 兼容19"国际标准、公制标准和ETSI标准。
- 机柜材质: 立梁(方孔条)耐指纹覆铝锌板。其他为SPCC优质冷轧钢板制做。
- 材料厚度: 立梁(方孔条): 2.0mm, 横梁: 1.5mm, 其他: 1.2mm。
- 承重: 额定静载≤800Kg。
- 防护等级: IP20。
- 柜门通风率: ≥75%。
- 表面处理: 脱脂、酸洗、磷化、静电喷涂。
- 颜色: RAL9004(黑色), RAL7035(灰白)。
- Standard: Comply with ANSI/EIARS-310-D, DIN41491; PART 1, IEC297-2, DIN41494; PART7, GB/T3047.2-92 standard. Compatible with metric ETSI and 19 inch international standard.
- Material: Zinc plated mounting profiles, SPCC Cold rolled steel.
- Material thickness: Mounting profile: 2.0mm, mounting rails: 1.5mm others: 1.2mm.
- Loading Capacity: 800kg.
- Protection grade: IP20.
- Ventilation Rate of Cabinet doors: ≥75%.
- Surface Finish: Degreasing, Pickling, Phosphating, Powder coating.
- Color: RAL9004(Black), RAL7035(Grey white).



可选配双开门
Double door type is optional



圆网孔托盘(可选)
Circular mesh fixed shelf(Optional)



8孔PDU竖装电源
8 ways vertical PDU



接地标识
Grounding mark



顶部预制走线孔
Pre-punched holes for cabling



散热风机组(选配)
Cooling fan unit (Optional)

户外防雨设备箱 Outdoor Cabinet



型号/ Model:FYX-02

- 名称: 室外防雨设备箱
- 特点: 防雨、防锈、防腐蚀。
- 材质: SPCC优质冷轧钢板、镀锌钢板、201不锈钢板、304不锈钢板。
- 防护等级: Ip55。
- 表面处理: 脱脂、水洗、陶化、静电喷涂。
- 颜色: RAL7035 (灰白)。
- 非标可来图定制。
- Product: Outdoor Cabinet
- Features: Rain-proof, rust-proof, corrosion-proof
- Material: SPCC cold-rolled steel, galvanized steel, 201 stainless steel, 304 stainless steel
- Protection Grade: IP55
- Surface Finish: Degreasing, washing, ceramics, electrostatic spraying.
- Color: RAL7035 (grey white)
- Customized products are acceptable.

手提式配电箱 Temporary Distribution Cabinet



型号/ Model:FYX-03

- 名称: 工地移动临时配电箱
- 特点: 防雨、防尘、接线即用。
- 材质: SPCC优质冷轧钢板。
- 防护等级: Ip55。
- 表面处理: 脱脂、水洗、陶化、静电喷涂。
- 颜色: 红色。
- Product: Temporary Distribution Cabinet
- Features: Rain-proof, rust-proof, ready to use
- Material: SPCC cold-rolled steel
- Protection Grade: IP55
- Surface Finish: Degreasing, washing, ceramics, electrostatic spraying.
- Color: Red

户外网络防雨柜 Outdoor Cabinet



型号/ Model:FYG-01

- 名称:落地式网络防雨柜
- 特点: 防雨、防锈、防腐蚀。
- 材质: SPCC优质冷轧钢板、镀锌钢板、201不锈钢板、304不锈钢板。
- 防护等级: Ip55。
- 表面处理: 脱脂、水洗、陶化、静电喷涂。
- 颜色: RAL7035 (灰白)。
- 非标可来图定制。
- Product:Outdoor Cabinet
- Features: Rain-proof, rust-proof, corrosion-proof
- Material: SPCC cold-rolled steel, galvanized steel, 201 stainless steel, 304 stainless steel
- Protection Grade:IP55
- Surface Finish: Degreasing, washing, ceramics, electrostatic spraying.
- Color: RAL7035(grey white)
- Customized products are acceptable.

开放式机架 Open Rack



型号/ Model: FYX-02

容量	尺寸
Capacity	Dimension
18U	1000mm
22U	1200mm
27U	1400mm
32U	1600mm
37U	1800mm
42U	2000mm

标准:

符合ANSI/EIA RS-310-D、IEC297-2、DIN41491;PART1、DIN41494; PART7、GB/T3047.2-92标准;兼容ETSI标准。

特点:

- 组合式设计，架设容易，低成本;
- 高强度结构，易装卸、运送、装配;
- 19"标准安装
- 多项配备可依需求选购(如线槽、理线架、水平抽拉工作平台等等)

Standard:

Compliant with ANSI/EIA RS-310-D, IEC297-2/DIN41491; PART1, DIN41494; PART7/GB/T3047.2-92 standard; Compatible with ETSI standards.

Features:

- Combined design, easy to install, low cost;
- High strength structure, easy to load, unload, transport, and assemble;
- 19 "standard installation
- Multiple equipment options can be purchased according to demand (such as cable trays, cable racksHorizontal pulling work platform, etc.)

- 机架材质: SPCC优质冷轧钢板制做。
- 材料厚度:整体2.0mm冷轧钢板。
- 表面处理:脱脂、水洗、陶化、水洗、静电喷涂。
- 颜色: RAL9004 (黑色)。

- Rack material: Made of SPCC high-quality cold-rolled steel plate.
- Material thickness: overall 2.0mm cold-rolled steel plate.
- Surface treatment: degreasing, water washing, ceramic coating, water washing, electrostatic spraying.
- Color: RAL9004 (black).



型号/ Model:E3-WM

E3-WM系列机柜标准配置 Cabinet Package Contents:

- | | | | |
|-----------|-----------------------|----------|------------------|
| ● 框架2个 | Cabinet Frame 2pcs | ● 侧板2个 | Side Panel 2pcs |
| ● 通风顶盖1个 | Top Cover 1pc | ● 底板1个 | Bottom Panel 1pc |
| ● 玻璃前门1扇 | Glass Front door 1pc | ● 柜门钥匙1套 | Keys 1set |
| ● 卡母+螺丝1包 | Cage nuts&screws 1bag | | |



型号/Model:F3-WM-6U



型号/Model:F3-WM-9U



型号/Model:F3-WM-12U

规格参数Specification

订购代码	容量	宽度(mm)	深度(mm)	整装体积
Model No.	Capacity	Width(mm)	Depth(mm)	Assembled packing(CBM)
F3WM5404	4U	543	450	0.08
F3WM5406	6U			0.10
F3WM5409	9U			0.14
F3WM5412	12U			0.17
F3WM5415	15U			0.21
F3WM5418	18U	543	600	0.25
F3WM5606	6U			0.13
F3WM5609	9U			0.18
F3WM5612	12U			0.23
F3WM5615	15U			0.28
F3WM5618	18U	600	450	0.32
F3WM6406	6U			0.11
F3WM6409	9U			0.15
F3WM6412	12U			0.19
F3WM6415	15U			0.23
F3WM6418	18U	600	600	0.27
F3WM6606	6U			0.15
F3WM6609	9U			0.20
F3WM6612	12U			0.25
F3WM6615	15U			0.31
F3WM6618	18U			0.36

- 机柜标准: 符合GB/T3047.2-92标准, 兼容19"国际标准、公制标准和ETSI标准。
- 机柜材质: SPCC优质冷轧钢板。
- 材料厚度: 立梁(方孔条): 2.0mm, 横梁: 1.5mm, 其他: 1.2mm。
- 承重: 额定静载≤80Kg。
- 防护等级: IP20。
- 表面处理: 脱脂、酸洗、磷化、静电喷涂。
- 颜色: RAL9004(黑色), RAL7035(灰白)。
- Standard: Comply with ANSI/EIARS-310-D, DIN41491; PART 1, IEC297-2, DIN41494; PART7, GB/T3047.2-92 standard. Compatible with metric ETSI and 19 inch international standard.
- Material: SPCC Cold Rolled steel.
- Material thickness: Mounting profile: 2.0mm, mounting rails: 1.5mm, mothers: 1.2mm.
- Loading Capacity: 80kg.
- Protection grade: IP20.
- Surface Finish: Degreasing, Pickling, Phosphating, Powder coating.
- Color: RAL9004(Black), RAL7035(Grey white).



快开侧面板
Quick open side panel



顶部背部进线孔
Pre-punched holes for cabling



风扇通风孔
Pre-punched holes for air flow



通风孔
Pre-punched holes for air flow



顶部背部进线孔
Pre-punched holes for cabling

型号/ Model: E-WM

E-WM系列机柜标准配置 Cabinet Package Contents:

- 框架2个 Cabinet Frame 2pcs
- 通风顶盖1个 Top Cover 1pc
- 玻璃前门1扇 Glass Front door 1pc
- 卡母+螺丝1包 Cage nuts&screws 1bag
- 侧板2个 Side Panel 2pcs
- 柜门钥匙1套 Keys 1set

规格参数Specification

订购代码	容量	宽度(mm)	深度(mm)	整装体积
Model No.	Capacity	Width(mm)	Depth(mm)	Assembled packing(CBM)
FWMG6506	6U	600	450	0.15
FWMG6509	9U			0.19
FWMG6512	12U			0.25
FWMG6515	15U			0.29
FWMG6518	18U			0.34
FWMG6606	6U	600	600	0.16
FWMG6609	9U			0.21
FWMG6612	12U			0.27
FWMG6615	15U			0.32
FWMG6618	18U			0.37

- 机柜标准: 符合GB/T3047.2-92标准, 兼容19"国际标准、公制标准和ETSI标准。
- 机柜材质: SPCC优质冷轧钢板。
- 材料厚度: 立梁(方孔条): 2.0mm, 横梁: 1.5mm, 其他: 1.2mm。
- 承重: 额定静载≤80Kg。
- 防护等级: IP20。
- 表面处理: 脱脂、酸洗、磷化、静电喷涂。
- 颜色: RAL9004(黑色), RAL7035(灰白)。
- Standard: Comply with ANSI/EIARS-310-D, DIN41491; PART 1, IEC297-2, DIN41494; PART7, GB/T3047.2-92 standard. Compatible with metric ETSI and 19 inch international standard.
- Material: SPCC Cold Rolled steel.
- Material thickness: Mounting profile: 2.0mm, mounting rails: 1.5mm, mothers: 1.2mm.
- Loading Capacity: 80kg.
- Protection grade: IP20.
- Surface Finish: Degreasing, Pickling, Phosphating, Powder coating.
- Color: RAL9004(Black), RAL7035(Grey white).

机柜常用配件 Cabinet Accessories



安装螺丝
Cage nuts and screws



平衡地脚
Leveling feet



承重脚轮
Castor



弹力锁
Handle lock



月光锁
Moonlight lock



小圆锁
Round lock



金属理线环
Metal cable management rings



F系列机柜并柜件
F Series cabinet combined accessories



H系列机柜并柜件
H series cabinet combined accessories



盲板
Blanking Panel



托板
Fixed shelf



滑动托盘
Sliding shelf



风扇组
Fan Units



A系列底座
A series cabinet base



H系列底座
H series cabinet Base



六位通用PDU
6 ways universal sockets



英标六位PDU
6 ways UK type PDU



欧标八位PDU
8 ways Euro type PDU

MERAVO[®]



北京盖非科技有限公司

BEIJING GAIFLY TECHNOLOGY CO.,LTD

地址：北京市顺义区空港融慧园海高大厦

电话：4008607228 Email: Gaifly@gai-fly.com